

**G-7000**



**Stronger for longer**

**GARAGA**

**INDUSTRIAL**

 **GARAGA®**

## G-7000

### Features

- 1 26-gauge hot-galvanized steel with woodgrain finish on both sides of the door.
- 2 Rustproof baked-on polyester paint (2 layers). Offered in Ice White only. Can be repainted.
- 3 1 3/8 in. (35 mm) thick insulated door with high-pressure injected polyurethane foam ensuring a high thermal-resistance rating of R-12 (RSI 2.1) ( $k=0.476 \text{ W/m}^2\text{K}$ ) and the solidity of a composite material.
- 4 Solid mechanical overlap joint: increases the weather-tightness of the door and prevents delamination.
- 5 Thermal break between the interior and exterior faces of each section.
- 6 Flexible tubular bottom weatherstripping ensuring the weather-tightness of the threshold.
- 7 14-gauge reinforcement plates placed in the interior of the door where hinges and handles are attached.
- 8 Wood end blocks, guaranteed against cracking, provide a full thermal break with the exterior of the door. Steel end caps are available as an option.
- 9 Door weight: 1.75 lb/ft<sup>2</sup> (8.5 kg/m<sup>2</sup>).
- 10 13-gauge or 14-gauge, 2 in. (51 mm) commercial tracks (for doors less than 140 ft<sup>2</sup> (13 m<sup>2</sup>)) or 12-gauge 3 in. (76 mm) industrial tracks. Torsion springs from 25 000 to 200 000 cycles (optional) are recommended for high usage doors.

Technical specifications and shop drawings of the G-7000 door are available on our web site at the following address:

[www.garaga.com/specs-commericals-garage-door-g7000\\_73.aspx](http://www.garaga.com/specs-commericals-garage-door-g7000_73.aspx)

Garaga guarantees its products for 10 years against any perforation of steel due to rust, 10 years on the wood end blocks against cracking and rot, 5 years against delamination of the steel from the polyurethane foam and one year on other components. Some restrictions apply. Contact our customer service department.

Garaga has established a permanent research program for all of its products.

Technical specifications for this door are subject to change without notice.

### Windows

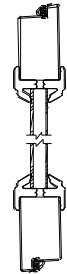

Sealed thermal glass is inserted into an expanded PVC frame which is cast without joints and guaranteed for 10 years against discoloration.

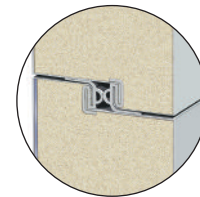

INTERLOK™ solid mechanical interlocking joint with double contact intersection moulding

Steel reinforcement plates for hinges and handles

26-gauge, galvanized steel

High-pressure injected polyurethane foam

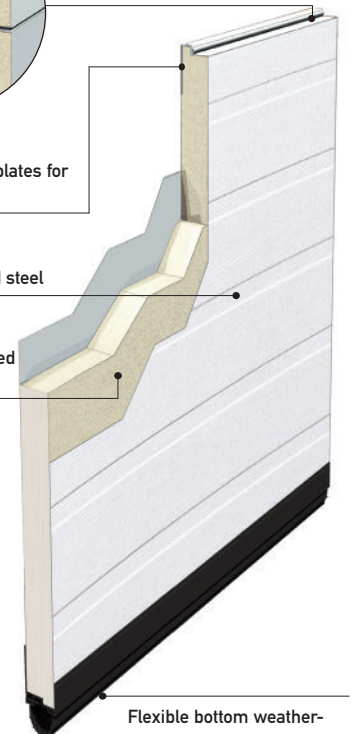

Flexible bottom weatherstripping that ensures the weather-tightness of the threshold

### Colour and model available

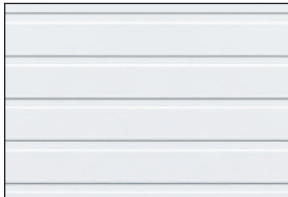

Ice White with grooves

### Available sizes

#### Widths:

from 5 to 16 ft. in 1-in. increments  
(from 1524 to 4876 mm,  
in 25.4 mm increments)

#### Heights:

from 8 to 16 ft  
(2438 mm to 4876 mm)  
Sections of 19.5, 21 and 24 in.  
(Sections of 495, 533 and 610 mm)



### GARAGA Inc.

8500, 25<sup>th</sup> Avenue, St-Georges, QC Canada G6A 1K5  
Tel.: **418 227-9458** Fax: 418 227-6282 E-mail: [info@garaga.com](mailto:info@garaga.com)  
[www.garaga.com](http://www.garaga.com)



Products manufactured in Canada  
© Garaga Inc. 2009 - All rights reserved

